

Calculation Summary									
Label	Qty	Label	Arrangement	Description	Units	Avg	Max	Min	Avg/Min
Front Sidewalk	3	SB	Single	Xtra Light VN1S-18000L-40K-DIM-5S-N-XX-XX	Fc	3.47	7.3	1.0	3.47
Parking Lot	8	SA	Single	Xtra Light VN1S-18000L-XX-DIM-4M-N-XX-XX-HSS	Fc	3.13	6.8	1.2	2.61
Property Line	62	B	Single	PIL INDEX+-360-18W-XX-XX-UNV-XX	Fc	0.24	1.1	0.0	N.A.
Rear Sidewalk					Fc	3.00	5.1	1.1	2.73
Sidewalk					Fc	2.46	3.3	1.1	2.24

Luminaire Schedule	Qty	Label	Arrangement	Description	LLF	Luminaire Lumens	Luminaire Watts	Total Watts
	3	SB	Single	Xtra Light VN1S-18000L-40K-DIM-5S-N-XX-XX	0.900	18189	128.7	386.1
	8	SA	Single	Xtra Light VN1S-18000L-XX-DIM-4M-N-XX-XX-HSS	0.900	12006	129	1032
	62	B	Single	PIL INDEX+-360-18W-XX-XX-UNV-XX	0.900	2120	17	1054

R W A Y

 NANCY WATERWAY

 70' CANAL RIGHT-OF-WAY

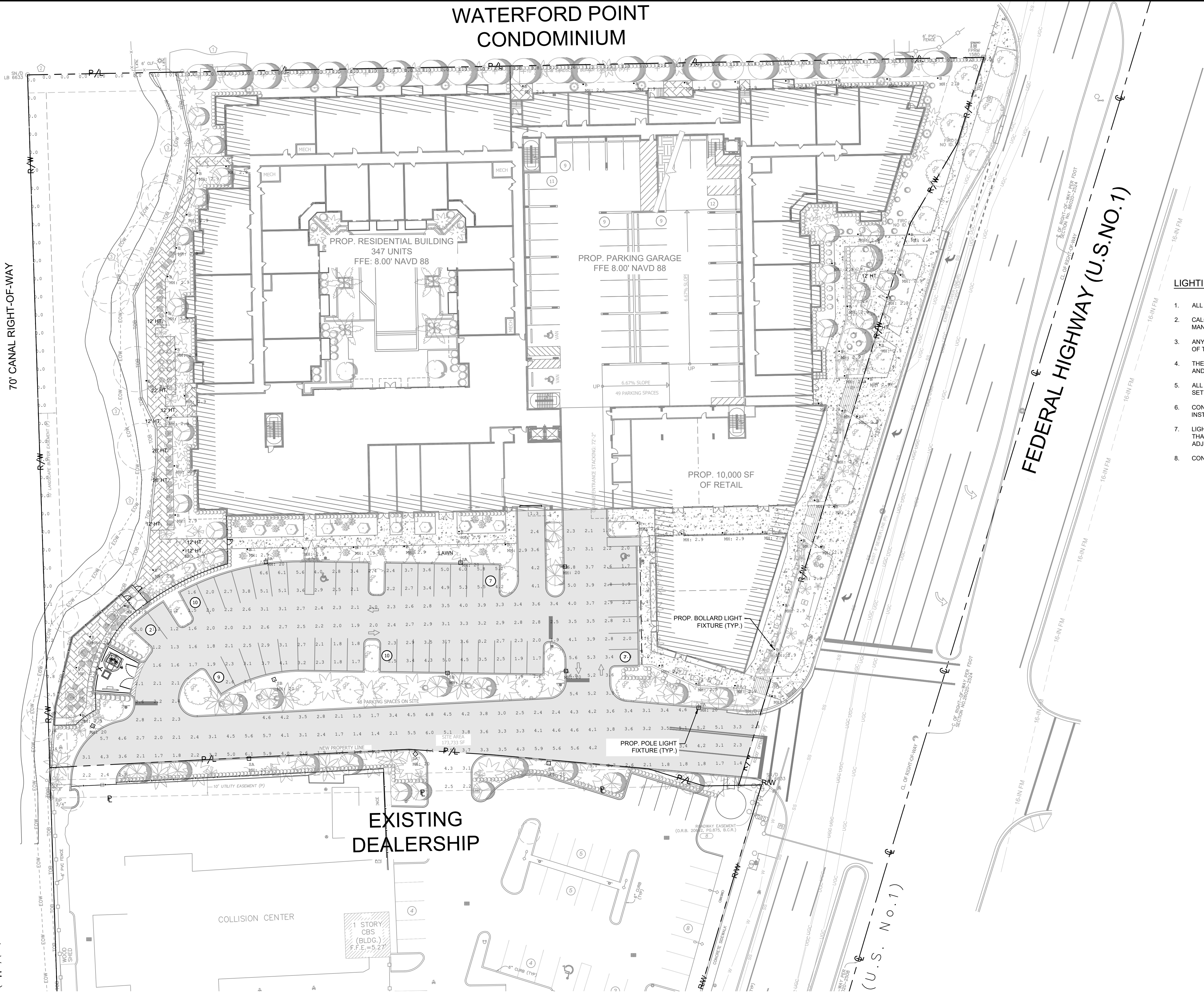

LEGEND:

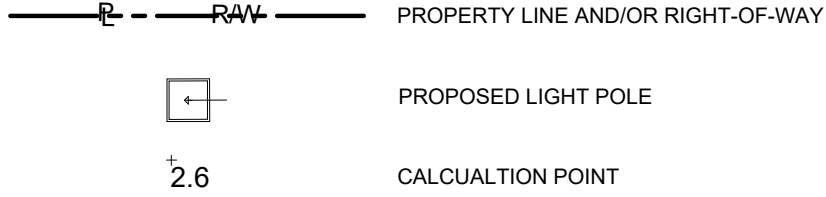

LIGHTING NOTES:

- ALL WORK AND MATERIALS SHALL COMPLY WITH ALL CITY/COUNTY/STATE REGULATION AND CODES.
- CALCULATED VALUES ARE DERIVED THROUGH A COMPUTER BASED MODEL WITH LIGHT FIXTURE DATA AS SUPPLIED BY MANUFACTURER THROUGH IES FILES.
- ANY DEVIATION FROM SPECIFIED FIXTURE MODELS AND MOUNTING HEIGHTS IN THIS EXHIBIT WILL DISCOUNT THE VALIDITY OF THESE CALCULATIONS.
- THE PHOTOMETRIC ANALYSIS EXCLUDES ALL PROPOSED OFF-SITE STREET LIGHTING, PROPOSED LANDSCAPE LIGHTING, AND EXISTING OFF-SITE LIGHTING.
- ALL LUMINAIRE SYMBOLS ARE DIAGRAMMATIC ONLY. CONTRACTOR TO FIELD COORDINATE EXACT LOCATIONS AND SETBACKS AGAINST UNDERGROUND UTILITY AND OTHER OBSTRUCTIONS.
- CONTRACTOR TO FIELD VERIFY FIXTURE VOLTAGE AND FINISH WITH OWNER AND ARCHITECT PRIOR TO PURCHASE AND INSTALLATION.
- LIGHT FIXTURES SHALL BE FULLY INTEGRATED WITH INTERIOR LIGHTING SYSTEM. PROVIDE FULLY COMPATIBLE SYSTEM THAT INCLUDES TIMECLOCK OPERATION, INTEGRAL OCCUPANCY SENSING, REMOTE ACCESS AND CONTROL FOR ADJUSTMENT OF HIGH/LOW TRIMMING, ZONING, ETC.
- CONTRACTOR SHALL ENSURE PROPER EROSION CONTROL IS IN PLACE PRIOR TO DEMOLITION.

Kimley»Horn

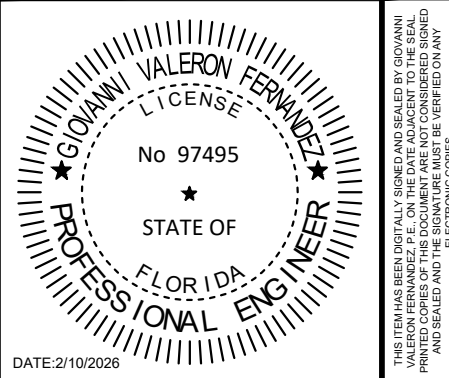

KHA PROJECT	DATE	SCALE	AS SHOWN	DESIGNED BY	GVF	DRAWN BY	EA	CHECKED BY	GVF
043175014	12/1/2025								

PHOTOMETRICS

 PLAN

MODERA POMPANO BEACH

 PREPARED FOR

 MCRT INVESTMENTS LLC

 FLORIDA

SHEET NUMBER

 C-600

NO.	REVISIONS	DATE	BY